

Carbide Punches with Air Hole, Carbide Head and Hardened Steel Collar

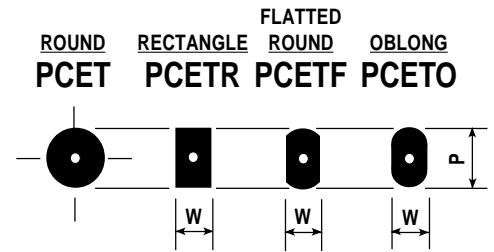
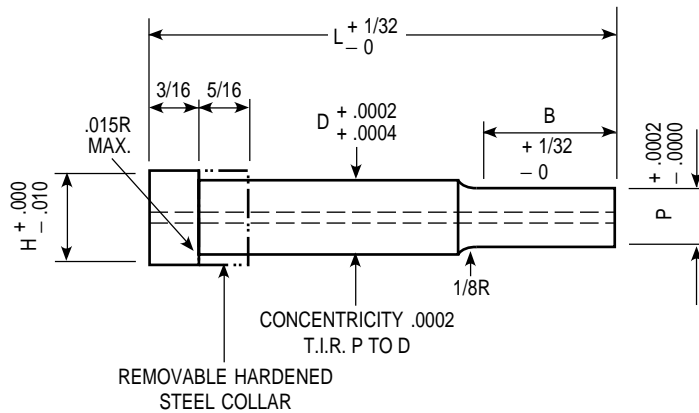

CATALOG NUMBER	D DIAMETER	P POINT DIAMETER	B POINT LENGTH	H HEAD DIAMETER	AIR HOLE DIA.	L = LENGTH									
						2	2 1/4	2 1/2	2 3/4	3	3 1/4	3 1/2	3 3/4	4	
* 1PCET-H18	.1875	.093 - .1259	3/4"	.250	3/64"	•	•	•	•	•	•	•	•	•	•
* 2PCET-H18	.1875	.126 - .1875	7/8"	.250	3/64"	•	•	•	•	•	•	•	•	•	•
1PCET-H25	.250	.093 - .1259	3/4"	.340	3/64"	•	•	•	•	•	•	•	•	•	•
2PCET-H25	.250	.126 - .250	7/8"	.340	3/64"	•	•	•	•	•	•	•	•	•	•
1PCET-H31	.3125	.125 - .2499	7/8"	.400	3/64"	•	•	•	•	•	•	•	•	•	•
2PCET-H31	.3125	.250 - .3125	7/8"	.400	3/64"	•	•	•	•	•	•	•	•	•	•
1PCET-H37	.375	.187 - .3139	7/8"	.460	5/64"	•	•	•	•	•	•	•	•	•	•
2PCET-H37	.375	.314 - .375	7/8"	.460	5/64"	•	•	•	•	•	•	•	•	•	•
1PCET-H43	.4375	.325 - .3749	7/8"	.562	7/64"	•	•	•	•	•	•	•	•	•	•
2PCET-H43	.4375	.375 - .4375	7/8"	.562	7/64"	•	•	•	•	•	•	•	•	•	•
1PCET-H50	.500	.375 - .4379	7/8"	.625	9/64"	•	•	•	•	•	•	•	•	•	•
2PCET-H50	.500	.438 - .500	7/8"	.625	9/64"	•	•	•	•	•	•	•	•	•	•
1PCET-H62	.625	.500 - .579	7/8"	.750	9/64"	•	•	•	•	•	•	•	•	•	•
2PCET-H62	.625	.575 - .625	7/8"	.750	9/64"	•	•	•	•	•	•	•	•	•	•

NOTE: ANY DIMENSION OTHER THAN THOSE SHOWN QUOTED ON REQUEST

All outside corners to be sharp unless otherwise specified by customer.

WHEN ORDERING SPECIFY:

Quantity	Catalog Number	L	P
3	1PCET-H25	3"	.1000"

Quantity	Catalog Number	L	Point Dimensions
12	1PCETR-H31	3"	W = .1875" P = .1500"

* Head Thickness = 1/8" with 3/8" Steel Collar.



This catalog covers +.0002/+ .0004" tolerance die components.
For +.00005/- .00000" tolerance die components, please refer to our precision catalog.