

Carbide Punches, Ball Retainer Type – Light Duty

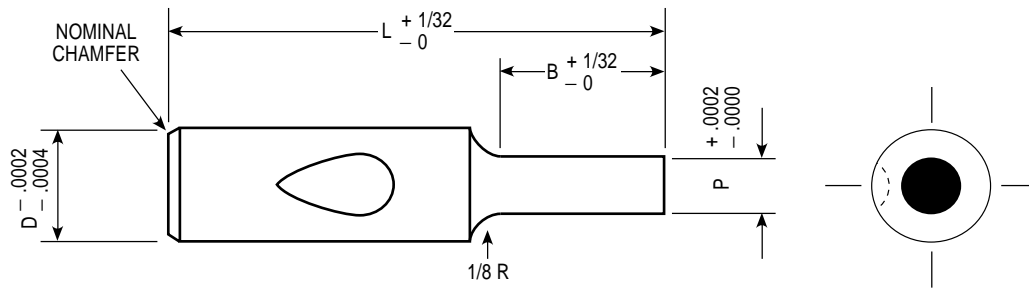

ROUND

CONCENTRICITY .0002" T.I.R. POINT TO SHANK

CATALOG NUMBER	D DIAMETER	P POINT DIAMETER	B POINT LENGTH	L = LENGTH						
				2	2¼	2½	2¾	3	3¼	3½
1PB-25	.250	.060 - .090	3/8"	•	•	•	•	•	•	•
2PB-25	.250	.0901 - .125	3/8"	•	•	•	•	•	•	•
3PB-25	.250	.1251 - .250	3/8"	•	•	•	•	•	•	•
1PB-37	.375	.187 - .250	1/2"	•	•	•	•	•	•	•
2PB-37	.375	.2501 - .313	1/2"	•	•	•	•	•	•	•
3PB-37	.375	.3131 - .375	1/2"	•	•	•	•	•	•	•
1PB-50	.500	.250 - .325	5/8"	•	•	•	•	•	•	•
2PB-50	.500	.3251 - .400	5/8"	•	•	•	•	•	•	•
3PB-50	.500	.4001 - .500	5/8"	•	•	•	•	•	•	•

NOTE: ANY DIMENSION OTHER THAN THOSE SHOWN QUOTED ON REQUEST

WHEN ORDERING SPECIFY:

Quantity	Catalog Number	L	P
3	1PB-50	2½"	.2630"

Note: Heavy duty available.



This catalog covers $+0.0002/+0.0004$ " tolerance die components.
For $+0.00005/-0.00000$ " tolerance die components, please refer to our precision catalog.