

Carbide Step-A-Head® Punches

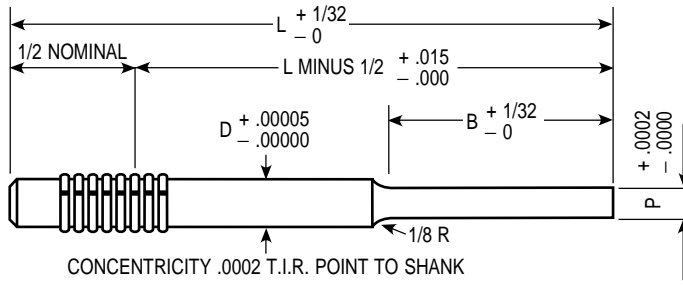

●
ROUND

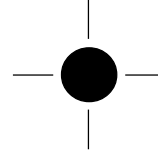

CATALOG NUMBER	D BODY DIAMETER	P POINT DIAMETER	B POINT LENGTH	L = LENGTH										
				2	2¼	2½	2¾	3	3¼	3½	3¾	4		
1PG-18	.1875	.0310 - .0609	5/16"	•	•	•	•	•	•	•	•	•	•	•
2PG-18	.1875	.0610 - .1875	3/4"	•	•	•	•	•	•	•	•	•	•	•
1PG-25	.250	.060 - .1259	3/4"	•	•	•	•	•	•	•	•	•	•	•
2PG-25	.250	.126 - .250	7/8"	•	•	•	•	•	•	•	•	•	•	•
1PG-31	.3125	.125 - .2499	7/8"	•	•	•	•	•	•	•	•	•	•	•
2PG-31	.3125	.250 - 3125	7/8"	•	•	•	•	•	•	•	•	•	•	•
1PG-37	.375	.187 - .3139	7/8"	•	•	•	•	•	•	•	•	•	•	•
2PG-37	.375	.314 - .375	7/8"	•	•	•	•	•	•	•	•	•	•	•
1PG-43	.4375	.314 - .3749	7/8"	•	•	•	•	•	•	•	•	•	•	•
2PG-43	.4375	.375 - .4375	7/8"	•	•	•	•	•	•	•	•	•	•	•



WHEN ORDERING SPECIFY:

Quantity	Catalog Number	L	P
3	2PG-25	3"	.140"

NOTE: ANY DIMENSION OTHER THAN THOSE SHOWN QUOTED ON REQUEST

Carbide Heavy Duty Step-A-Head® Punches

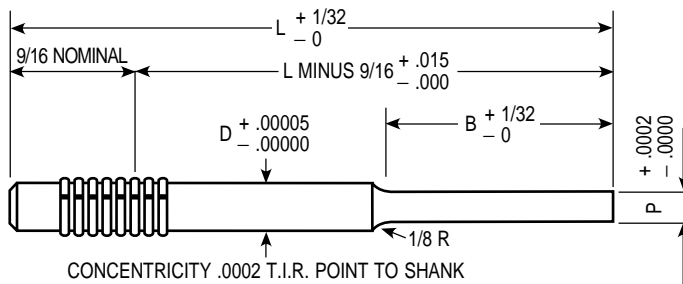

●
ROUND

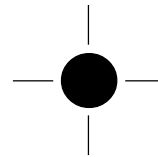

CATALOG NUMBER	D BODY DIAMETER	P POINT DIAMETER	B POINT LENGTH	L = LENGTH										
				2	2¼	2½	2¾	3	3¼	3½	3¾	4		
1PGH-50	.500	.375 - .4379	7/8"	•	•	•	•	•	•	•	•	•	•	•
2PGH-50	.500	.438 - .500	7/8"	•	•	•	•	•	•	•	•	•	•	•
1PGH-62	.625	.438 - .5299	7/8"	•	•	•	•	•	•	•	•	•	•	•
2PGH-62	.625	.530 - .625	7/8"	•	•	•	•	•	•	•	•	•	•	•
1PGH-75	.750	.530 - .6299	7/8"	•	•	•	•	•	•	•	•	•	•	•
2PGH-75	.750	.630 - .750	7/8"	•	•	•	•	•	•	•	•	•	•	•

WHEN ORDERING SPECIFY:

Quantity	Catalog Number	L	P
2	1PGH-75	3"	.612"

NOTE: ANY DIMENSION OTHER THAN THOSE SHOWN QUOTED ON REQUEST