

# Carbide Drill Jig Bushings

## Press Fit Type "CP" and "CH"

HEADLESS PRESS FIT TYPE "CP"

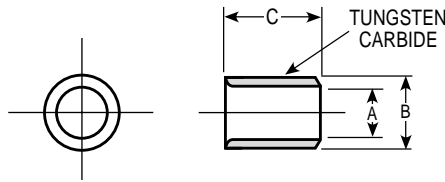

HEAD PRESS FIT TYPE "CH"

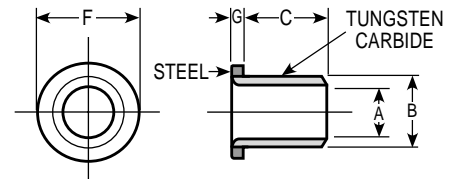

STANDARD DRILL SIZE A	ACTUAL O.D. B	LENGTH C	SYMBOL FOR O.D. FINISH GROUND
.0135 to .0200	.1578	1/4"	CP-10-4
	.1575	5/16"	CP-10-5
.0210 to .0312	.1578	1/4"	CP-10-4
	.1575	5/16"	CP-10-5
.0320 to .0469	.1578	1/4"	CP-10-4
	.1575	5/16"	CP-10-5
.0630 to .0995	.2046	1/4"	CP-13-4
	.2043	5/16"	CP-13-5
.1015 to .1360	.2516	1/4"	CP-16-4
	.2513	5/16"	CP-16-5
.1405 to .1875	.3141	5/16"	CP-20-5
	.3138	1/2"	CP-20-8
.1890 to .2500	.4078	1/2"	CP-26-5
	.4075	3/4"	CP-26-8
.2570 to .3125	.5017	3/4"	CP-32-5
	.5014	1"	CP-32-8
.3160 to .4219	.6267	1"	CP-40-8
	.6264	1-3/8"	CP-40-12
.4375 to .5000	.7518	1"	CP-48-8
	.7515	1-3/8"	CP-48-12
.5156 to .6250	.8768	1"	CP-56-12
	.8765	1-3/8"	CP-56-22
.6406 to .7500	1.0018	1"	CP-64-8
	1.0015	1-3/8"	CP-64-12
.7656 to 1.0000	1.3772	1"	CP-88-12
	1.3768	1-3/8"	CP-88-16
1.0156 to 1.3750	1.7523	1"	CP-112-16
	1.7519	1-3/8"	CP-112-22
1.3906 to 1.7500	2.2525	1"	CP-144-16
	2.2521	1-3/8"	CP-144-22

STANDARD DRILL SIZE A	ACTUAL O.D. B	LENGTH C	SYMBOL FOR O.D. FINISH GROUND
.4375 to .5000	.7518 .7515	1/2"	CP-48-8
		3/4"	CP-48-12
		1"	CP-48-16
.5156 to .6250	.8768 .8765	3/4"	CP-56-12
		1"	CP-56-16
		1-3/8"	CP-56-22
.6406 to .7500	1.0018 1.0015	1/2"	CP-64-8
		3/4"	CP-64-12
		1"	CP-64-16
.7656 to 1.0000	1.3772 1.3768	3/4"	CP-88-12
		1"	CP-88-16
		1-3/8"	CP-88-22
1.0156 to 1.3750	1.7523 1.7519	1"	CP-112-16
		1-3/8"	CP-112-22
		1-3/4"	CP-112-28
1.3906 to 1.7500	2.2525 2.2521	2-1/8"	CP-144-28
		2-1/2"	CP-144-34
		3"	CP-144-40

STANDARD DRILL SIZE A	ACTUAL O.D. B	LENGTH C	SYMBOL FOR O.D. FINISH GROUND	TYPE "CH" ONLY	
				F	G
.0630 to .0995	.2046 .2043	5/16"	CH-13-5	19/64"	3/32"
		1/2"	CH-13-8		
.1015 to .1360	.2516 .2513	5/16"	CH-16-5	23/64"	3/32"
		1/2"	CH-16-8		
.1405 to .1875	.3141 .3138	5/16"	CH-20-5	27/64"	1/8"
		1/2"	CH-20-8		
.1890 to .2500	.4078 .4075	3/4"	CH-20-12	27/64"	1/8"
		1"	CH-20-16		
.2570 to .3125	.5017 .5014	5/16"	CH-26-5	1/2"	5/32"
		1/2"	CH-26-8		
		3/4"	CH-26-12		
.3160 to .4219	.6267 .6264	1"	CH-26-16	1/2"	5/32"
		1-3/8"	CH-26-16		
		1"	CH-26-16		
.4375 to .5000	.7518 .7515	5/16"	CH-32-5	39/64"	7/32"
		1/2"	CH-32-8		
		3/4"	CH-32-12		
.5156 to .6250	.8768 .8765	1"	CH-32-16	39/64"	7/32"
		1-3/8"	CH-32-22		
		1-3/4"	CH-32-22		
.6406 to .7500	1.0018 1.0015	1/2"	CH-40-8	51/64"	7/32"
		3/4"	CH-40-12		
		1"	CH-40-16		
.7656 to 1.0000	1.3772 1.3768	1-3/8"	CH-40-22	51/64"	7/32"
		1"	CH-40-22		
		1-3/8"	CH-40-22		
1.0156 to 1.3750	1.7523 1.7519	1/2"	CH-48-8	59/64"	7/32"
		3/4"	CH-48-12		
		1"	CH-48-16		
1.3906 to 1.7500	2.2525 2.2521	1-3/8"	CH-48-22	59/64"	7/32"
		1"	CH-48-22		
		1-3/8"	CH-48-22		
.6406 to .7500	1.0018 1.0015	1/2"	CH-56-12	1-7/64"	1/4"
		3/4"	CH-56-16		
		1"	CH-56-22		
.7656 to 1.0000	1.3772 1.3768	1-3/8"	CH-56-22	1-7/64"	1/4"
		1"	CH-56-22		
		1-3/8"	CH-56-22		
1.0156 to 1.3750	1.7523 1.7519	1"	CH-64-8	1-15/64"	5/16"
		1-3/8"	CH-64-12		
		1-3/4"	CH-64-16		
1.3906 to 1.7500	2.2525 2.2521	1"	CH-64-16	1-15/64"	5/16"
		1-3/8"	CH-64-22		
		1-3/4"	CH-64-22		
.6406 to .7500	1.0018 1.0015	1/2"	CH-64-28	1-15/64"	5/16"
		3/4"	CH-64-28		
		1"	CH-64-28		
.7656 to 1.0000	1.3772 1.3768	3/4"	CH-88-12	1-39/64"	3/8"
		1"	CH-88-16		
		1-3/8"	CH-88-22		
1.0156 to 1.3750	1.7523 1.7519	1-3/4"	CH-88-22	1-39/64"	3/8"
		2-1/8"	CH-88-28		
		2-1/2"	CH-88-34		
1.3906 to 1.7500	2.2525 2.2521	2-1/2"	CH-88-40	1-39/64"	3/8"
		1"	CH-112-16		
		1-3/8"	CH-112-22		
1.0156 to 1.3750	1.7523 1.7519	1-3/4"	CH-112-28	1-63/64"	3/8"
		2-1/8"	CH-112-34		
		2-1/2"	CH-112-40		
1.3906 to 1.7500	2.2525 2.2521	3"	CH-112-48	1-63/64"	3/8"
		1"	CH-144-16		
		1-3/8"	CH-144-22		
1.0156 to 1.3750	1.7523 1.7519	1-3/4"	CH-144-28	2-31/64"	3/8"
		2-1/8"	CH-144-34		
		2-1/2"	CH-144-40		
1.3906 to 1.7500	2.2525 2.2521	3"	CH-144-48	2-31/64"	3/8"
		1"	CH-144-48		
		1-3/8"	CH-144-48		

NOTE: ANY DIMENSION OTHER THAN THOSE SHOWN QUOTED ON REQUEST

**Hole Tolerances:**

- Up to 1/4" +.0001 to +.0004
- Up to 3/4" +.0001 to +.0005
- Up to 1-1/2" +.0002 to +.0006
- Over 1-1/2" +.0003 to +.0007

Bodies of Carbide Bushings are solid Tungsten Carbide; Type "CH", "CSR" and "CFR" have Steel Heads. Concentricity held to within .0003.

All Removable Slip Fit Standard A.S.A. Carbide Bushings are ground on the O.D. with a Slip Fit clearance to fit into a Standard A.S.A. Steel Liner Bushing.