

Carbide Drill Jig Bushings Fixed Renewable Type "CFR"

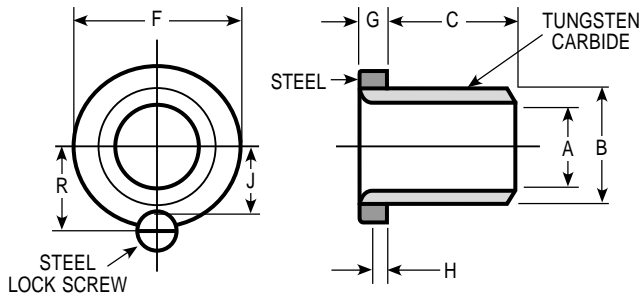

STANDARD DRILL SIZE A	ACTUAL O.D. B	LENGTH UNDER HEAD C	SYMBOL FOR O.D. FINISH GROUND	HEAD SIZE					LOCK SCREW TO USE
				F	G	H	J	R	
.0630 to .0890	.3125	5/16"	CFR-20-5	35/64"	1/4"	1/8"	11/64"	1/2"	1A
	.3123	1/2"	CFR-20-8						
		3/4"	CFR-20-12						
		1"	CFR-20-16						
.0935 to .1562	.3125	5/16"	CFR-20-5	35/64"	1/4"	1/8"	11/64"	1/2"	1A
	.3123	1/2"	CFR-20-8						
		3/4"	CFR-20-12						
		1"	CFR-20-16						
.1570 to .1875	.5000	5/16"	CFR-32-5	51/64"	1/4"	1/8"	19/64"	5/8"	1A
	.4998	1/2"	CFR-32-8						
		3/4"	CFR-32-12						
		1"	CFR-32-16						
		1-3/8"	CFR-32-22						
.1890 to .3125	.5000	5/16"	CFR-32-5	51/64"	1/4"	1/8"	19/64"	5/8"	1A
	.4998	1/2"	CFR-32-8						
		3/4"	CFR-32-12						
		1"	CFR-32-16						
		1-3/8"	CFR-32-22						
.3160 to .5000	.7500	1/2"	CFR-48-8	1-3/64"	1/4"	1/8"	27/64"	3/4"	1A
	.7498	3/4"	CFR-48-12						
		1"	CFR-48-16						
		1-3/8"	CFR-48-22						
.5156 to .7500	1.0000	1/2"	CFR-64-8	1-27/64"	3/8"	3/16"	19/32"	59/64"	2A
	.9998	3/4"	CFR-64-12						
		1"	CFR-64-16						
		1-3/8"	CFR-64-22						
		1-3/4"	CFR-64-28						
.7656 to 1.0000	1.3750	3/4"	CFR-88-12	1-51/64"	3/8"	3/16"	25/32"	1-7/64"	2A
	1.3747	1"	CFR-88-16						
		1-3/8"	CFR-88-22						
		1-3/4"	CFR-88-28						
		2-1/8"	CFR-88-34						
		2-1/2"	CFR-88-40						
1.0156 to 1.3750	1.7500	1"	CFR-112-16	2-19/64"	3/8"	3/16"	1"	1-25/64"	3A
	1.7497	1-3/8"	CFR-112-22						
		1-3/4"	CFR-112-28						
		2-1/8"	CFR-112-34						
		2-1/2"	CFR-112-40						
		3"	CFR-112-48						
1.3906 to 1.7500	2.2500	1"	CFR-144-16	2-51/64"	3/8"	3/16"	1-1/4"	1-41/64"	3A
	2.2496	1-3/8"	CFR-144-22						
		1-3/4"	CFR-144-28						
		2-1/8"	CFR-144-34						
		2-1/2"	CFR-144-40						
		3"	CFR-144-48						

Hole Tolerances:

Up to 1/4" +.0001 to +.0004
 Up to 3/4" +.0001 to +.0005
 Up to 1-1/2" +.0002 to +.0006
 Over 1-1/2" +.0003 to +.0007

Bodies of Carbide Bushings are solid Tungsten Carbide; Type "CH", "CSR" and "CFR" have Steel Heads. Concentricity held to within .0003.

All Removable Slip Fit Standard A.S.A. Carbide Bushings are ground on the O.D. with a Slip Fit clearance to fit into a Standard A.S.A. Steel Liner Bushing.

NOTE: ANY DIMENSION OTHER THAN THOSE SHOWN QUOTED ON REQUEST