

Carbide Die Inserts with Full Length Taper and Machinable Steel Sleeve Head

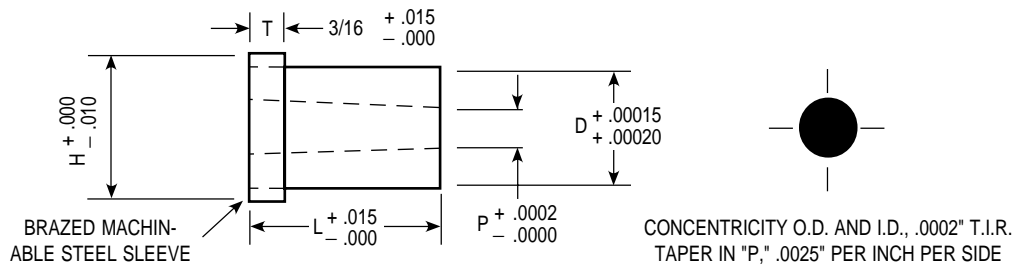

CATALOG NUMBER	D BODY DIAMETER	P INSIDE DIAMETER	H HEAD DIAMETER	L = LENGTH	
				1	1 1/4
1DTS-18	.1875	.030 - .0519	.296	•	•
2DTS-18	.1875	.052 - .0749	.296	•	•
3DTS-18	.1875	.075 - .0969	.296	•	•
1DTS-25A	.250	.030 - .0519	.340	•	•
1DTS-25	.250	.052 - .0749	.340	•	•
2DTS-25	.250	.075 - .0969	.340	•	•
3DTS-25	.250	.097 - .1199	.340	•	•
4DTS-25	.250	.120 - .156	.340	•	•
1DTS-31	.3125	.030 - .0519	.400	•	•
2DTS-31	.3125	.052 - .0749	.400	•	•
3DTS-31	.3125	.075 - .0969	.400	•	•
4DTS-31	.3125	.097 - .1199	.400	•	•
5DTS-31	.3125	.120 - .206	.400	•	•
1DTS-37	.375	.030 - .0519	.460	•	•
2DTS-37	.375	.052 - .0749	.460	•	•
3DTS-37	.375	.075 - .0969	.460	•	•
4DTS-37	.375	.097 - .1199	.460	•	•
5DTS-37	.375	.120 - .206	.460	•	•



WHEN ORDERING SPECIFY:

Quantity	Catalog Number	L	P
6	3DTS-37	1 1/4"	.0960"

NOTE: ANY DIMENSION OTHER THAN THOSE SHOWN QUOTED ON REQUEST

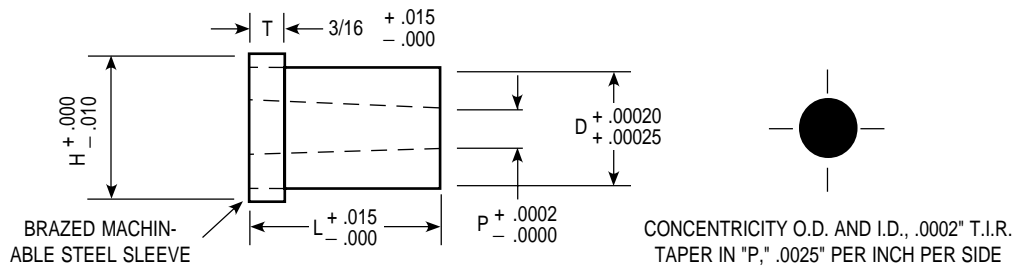

CATALOG NUMBER	D BODY DIAMETER	P INSIDE DIAMETER	H HEAD DIAMETER	L = LENGTH	
				1	1 1/4
1DTS-43	.4375	.156 - .2009	.562	•	•
2DTS-43	.4375	.201 - .248	.562	•	•
3DTS-43	.4375	.2481 - .336	.562	•	•
1DTS-50	.500	.156 - .2009	.625	•	•
2DTS-50	.500	.201 - .248	.625	•	•
3DTS-50	.500	.2481 - .336	.625	•	•
1DTS-62	.625	.260 - .396	.750	•	•
1DTS-75	.750	.3125 - .526	.875	•	•
1DTS-87	.875	.375 - .590	1.000	•	•
1DTS-100	1.000	.375 - .690	1.125	•	•

WHEN ORDERING SPECIFY:

Quantity	Catalog Number	L	P
6	3DTS-50	1 1/4"	.2960"

NOTE: ANY DIMENSION OTHER THAN THOSE SHOWN QUOTED ON REQUEST