

# Carbide Die Inserts with Counterbore

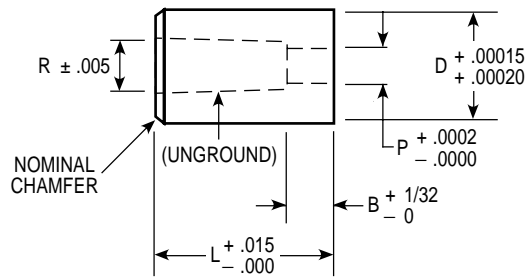

CONCENTRICITY O.D. AND I.D., .0002" T.I.R.  
TAPER IN "P," .0025" PER INCH PER SIDE

CATALOG NUMBER	D BODY DIAMETER	P INSIDE DIAMETER	R RELIEF DIAMETER	B LAND	L = LENGTH	
					1	1/4
1DC-18A	.1875	.052 - .0619	.080	1/8"	•	•
1DC-18B	.1875	.062 - .070	.090	1/8"	•	•
2DC-18A	.1875	.0701 - .077	.100	1/8"	•	•
2DC-18B	.1875	.0771 - .087	.108	3/16"	•	•
3DC-18A	.1875	.0871 - .092	.114	3/16"	•	•
1DC-25	.250	.052 - .0619	.080	1/8"	•	•
1DC-25A	.250	.062 - .070	.090	1/8"	•	•
1DC-25B	.250	.0701 - .077	.100	1/8"	•	•
2DC-25A	.250	.0771 - .087	.108	3/16"	•	•
2DC-25B	.250	.0871 - .092	.114	3/16"	•	•
3DC-25A	.250	.0921 - .108	.125	3/16"	•	•
3DC-25B	.250	.1081 - .124	.144	3/16"	•	•
4DC-25	.250	.1241 - .140	.159	1/4"	•	•
1DC-31A	.3125	.062 - .070	.090	1/8"	•	•
1DC-31B	.3125	.0701 - .077	.100	1/8"	•	•
2DC-31A	.3125	.0771 - .087	.108	3/16"	•	•
2DC-31B	.3125	.0871 - .092	.114	3/16"	•	•
3DC-31A	.3125	.0921 - .108	.125	3/16"	•	•
3DC-31B	.3125	.1081 - .124	.144	3/16"	•	•
4DC-31	.3125	.1241 - .140	.159	1/4"	•	•
5DC-31	.3125	.1401 - .180	.209	1/4"	•	•
6DC-31	.3125	.1801 - .195	.219	1/4"	•	•
1DC-37A	.375	.062 - .070	.090	1/8"	•	•
1DC-37B	.375	.0701 - .077	.100	1/8"	•	•
2DC-37A	.375	.0771 - .087	.108	3/16"	•	•
2DC-37B	.375	.0871 - .092	.114	3/16"	•	•
3DC-37A	.375	.0921 - .108	.125	3/16"	•	•
3DC-37B	.375	.1081 - .124	.144	3/16"	•	•
4DC-37	.375	.1241 - .140	.159	1/4"	•	•
5DC-37	.375	.1401 - .180	.209	1/4"	•	•
6DC-37	.375	.1801 - .195	.219	1/4"	•	•



NOTE: ANY DIMENSION OTHER THAN THOSE SHOWN QUOTED ON REQUEST

### WHEN ORDERING SPECIFY:

Quantity	Catalog Number	L	P
6	4DC-31	1"	.1250"

# Carbide Die Inserts with Counterbore

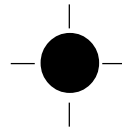
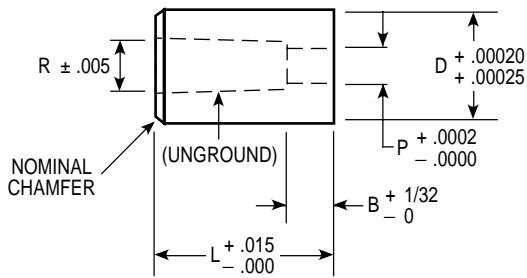

**ROUND**

CONCENTRICITY O.D. AND I.D., .0002" T.I.R.  
TAPER IN "P," .0025" PER INCH PER SIDE

CATALOG NUMBER	D BODY DIAMETER	P INSIDE DIAMETER	R RELIEF DIAMETER	B LAND	L = LENGTH	
					1	1¼
1DC-43	.4375	.156 - .200	.219	1/4"	•	•
2DC-43	.4375	.2001 - .248	.269	3/8"	•	•
3DC-43	.4375	.2481 - .300	.319	3/8"	•	•
1DC-50A	.500	.156 - .200	.219	1/4"	•	•
2DC-50	.500	.2001 - .248	.269	3/8"	•	•
3DC-50	.500	.2481 - .300	.319	3/8"	•	•
1DC-62A	.625	.260 - .310	.399	3/8"	•	•
2DC-62	.625	.3101 - .375	.399	3/8"	•	•
3DC-62	.625	.3751 - UP	.469	3/8"	•	•
1DC-75	.750	.3125 - .510	P + .02	3/8"	•	•
1DC-87	.875	.375 - .515	P + .02	3/8"	•	•
1DC-100	1.000	.375 - .675	P + .02	3/8"	•	•

NOTE: ANY DIMENSION OTHER THAN THOSE SHOWN QUOTED ON REQUEST

### WHEN ORDERING SPECIFY:

Quantity	Catalog Number	L	P
6	1DC-50A	1¼"	.1830"