

METRIC

Carbide Punches with Air Hole, Carbide Head and Hardened Steel Collar

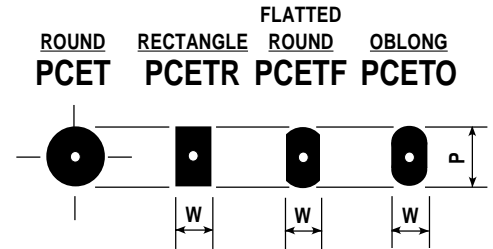
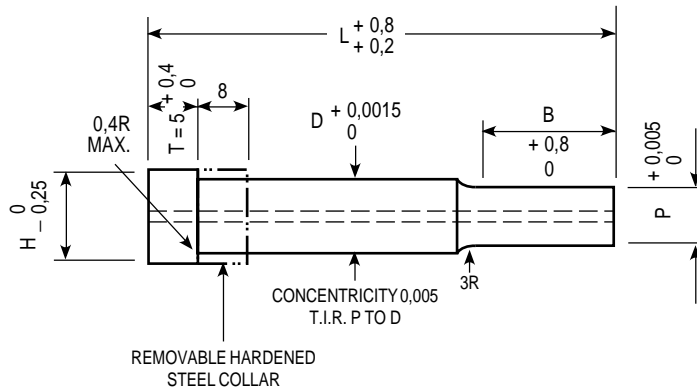

CATALOG NUMBER	D BODY DIAMETER	P POINT DIAMETER	B POINT LENGTH	H HEAD DIAMETER	L = LENGTH						
					AIR HOLE DIA.	50	60	70	80	90	100
1PCET-5M	5,0	2,50 - 5,00	20	8,00	1,2	•	•	•	•	•	•
1PCET-6M	6,0	2,50 - 6,00	20	9,00	1,2	•	•	•	•	•	•
1PCET-8M	8,0	4,00 - 8,00	22	11,00	1,2	•	•	•	•	•	•
1PCET-10M	10,0	7,00 - 10,00	22	13,00	2,8	•	•	•	•	•	•
1PCET-13M	13,0	10,00 - 13,00	22	16,00	3,6	•	•	•	•	•	•
1PCET-16M	16,0	11,00 - 16,00	22	19,00	3,6	•	•	•	•	•	•
1PCET-20M	20,0	15,00 - 20,00	22	23,00	3,6	•	•	•	•	•	•

All outside corners to be sharp unless otherwise specified by customer.

NOTE: ANY DIMENSION OTHER THAN THOSE SHOWN QUOTED ON REQUEST



WHEN ORDERING SPECIFY:

Quantity	Catalog Number	L	P
5	1PCET-8M	60	5,50

Quantity	Catalog Number	L	Point Dimensions
12	1PCETR-8M	60	W = 4,50 P = 5,50